

# PRODUCT DATA SHEET

2024-04-08



Article number:

5810000933GS

Swivel castor 100 mm, elastic rubber-tyre

Swivel bracket. Made of zinc-chromatized pressed sheet metal with double ball race swivel. Center hole fitting.. Wheel axle with nut. Wheel with grey elastic rubber-tyre. Hub made of black Nylon/PA6 with threadguards. Ball bearing.



Image may differ from the actual product.\*

## DIMENSIONS

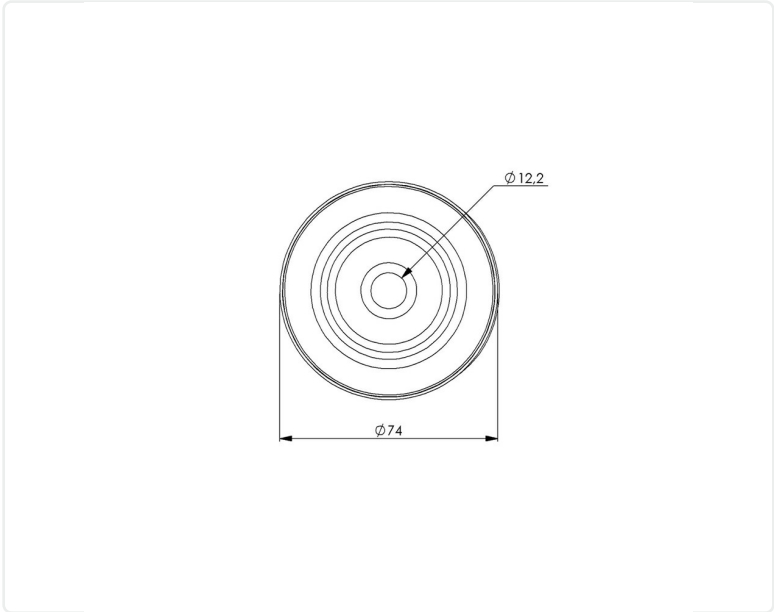

## SPECIFICATIONS

Diameter	100 mm
Totalt height	132 mm
Load Capacity (dynamic)	225 kg
Castor model	Swivel
Fitting	Centre hole
Material Tread	Elastic Rubber
Bearing	Ball bearing
Thread hardness (Shore°)	75° Shore A
Centre Bolt Hole	12.4 mm
Width of tread	36 mm
Hub Hole Diameter	10 mm
Material Hub	Nylon PA6
Fork Width	47 mm
Color Tread	Grey
Material Type	RoHS (EU) - Approved
Teststandard	EN 12532
Offset	41 mm
Material Thickness Bracket	2.5 mm
Swivel radius	91 mm
Product Weight	0.86 kg
Temperature Range	-30°C to +70°C

Numeric values in the technical specification can be nominal/rounded to the cneares standard dimension. To see exact values, please use the drawing.