

PRODUCT DATA SHEET

2024-02-09



Article number:

5816680222N

Swivel castor 160 mm, PA6-wheel

Swivel bracket. Made of zinc-chromatized pressed sheet metal with double ball race swivel. Top plate fitting. Wheel axle with nut. Wheel made of nature Nylon/PA6. Roller bearing.



Image may differ from the actual product.*

DIMENSIONS

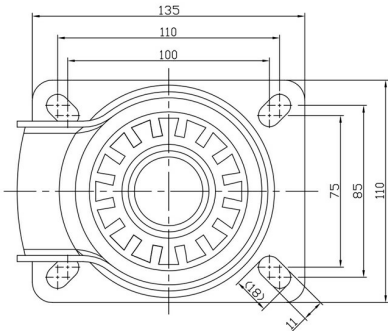

SPECIFICATIONS

Diameter	160 mm
Totalt height	195 mm
Load Capacity (dynamic)	350 kg
Castor model	Swivel
Fitting	Top plate
Material Tread	Nylon PA6
Bearing	Roller bearing
Plate Size	140x110 mm
CC Distance	105x80 mm
Thread hardness (Shore°)	75° Shore D
Width of tread	48 mm
Material Hub	Nylon PA6
Top Hole	11x14 mm
Color Tread	Nature
Material Type	RoHS (EU) - Approved
Teststandard	EN 12532
Offset	53 mm
Material Thickness Bracket	3 mm
Materialthicknessplate	3.5 mm
Product Weight	1.75 kg
Temperature Range	-20°C to +50°C

Numeric values in the technical specification can be nominal/rounded to the nearest standard dimension. To see exact values, please use the drawing.