

PRODUCT DATA SHEET

2024-02-06



Article number:

5810665933GS

Braked castor 100 mm, total stop brake, elastic rubber-tyre

Swivel bracket with total stop brake. Made of zinc-chromatized pressed sheet metal with double ball race swivel. Top plate fitting. Wheel axle with nut. Wheel with grey elastic rubber-tyre. Hub made of black Nylon/PA6 with threadguards. Ball bearing.



Image may differ from the actual product.*

DIMENSIONS

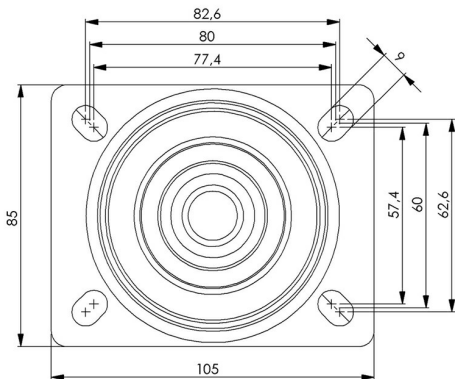

SPECIFICATIONS

Diameter	100 mm
Totalt height	132 mm
Load Capacity (dynamic)	225 kg
Castor model	Brake
Fitting	Top plate
Material Tread	Elastic Rubber
Bearing	Ball bearing
Plate Size	105x85 mm
CC Distance	80x60 mm
Thread hardness (Shore°)	75° Shore A
Brake	Total brake
Width of tread	36 mm
Material Hub	Nylon PA6
Top Hole	12,5x9 mm
Color Tread	Grey
Material Type	RoHS (EU) - Approved
Teststandard	EN 12532
Offset	41 mm
Material Thickness Bracket	2.5 mm
Materialthickplate	3 mm
Swivel radius	129 mm
Product Weight	1.11 kg
Temperature Range	-30°C to +70°C

Numeric values in the technical specification can be nominal/rounded to the nearest standard dimension. To see exact values, please use the drawing.