

PRODUCT DATA SHEET

2024-02-09



Article number:

5516680322SS

Fixed castor 160 mm, rubber-tyre

Fixed bracket made of zinc-chromatized pressed sheet metal. Top plate fitting. Wheel axle with nut. Wheel with black rubber-tyre. Hub made of black PP. Roller bearing.



Image may differ from the actual product.*

DIMENSIONS

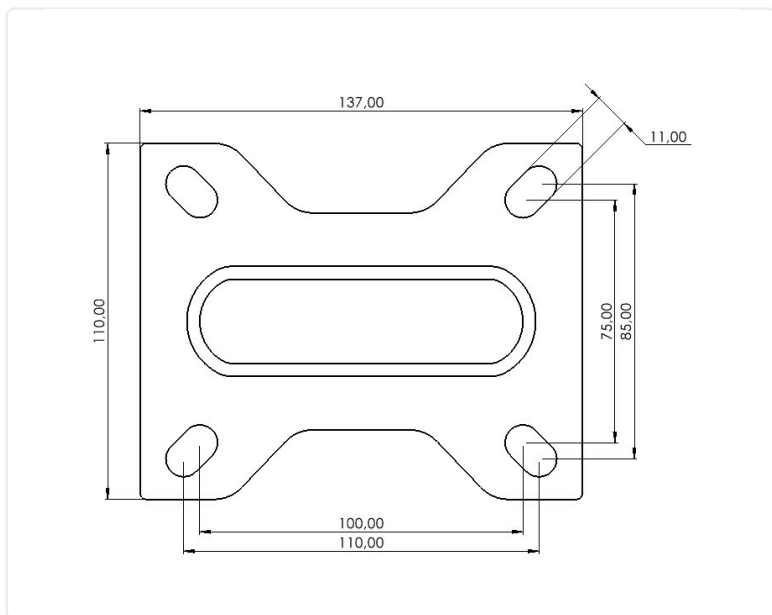

SPECIFICATIONS

Diameter	160 mm
Total height	195 mm
Load Capacity (dynamic)	160 kg
Castor model	Fix
Fitting	Top plate
Material Tread	Rubber
Bearing	Roller bearing
Plate Size	140x110 mm
CC Distance	105x80 mm
Thread hardness (Shore°)	85° Shore A
Width of tread	40 mm
Material Hub	Polypropylen (pp)
Top Hole	11x18 mm
Fixed	Yes
Color Tread	Black
Material Type	RoHS (EU) - NOT Approved
Teststandard	EN 12532
Material Thickness Bracket	2,5 mm
Product Weight	1,66 kg
Temperature Range	-20°C to +60°C

Numeric values in the technical specification can be nominal/rounded to the nearest standard dimension. To see exact values, please use the drawing.